

Automatic Transfer Switch Equipment L2Hxx-xxx/2



- PC-Class change-over switch
- Dual power supply design: power supply I (main) and power supply II (standby)
- Supports AC systems with a rated current of 10 A to 63 A
- Automatic switching time 20 milliseconds
- Compliance with IEC 60947-6-1:2021

The L2H Automatic Transfer Switch Equipment (ATSE) is a PC-Class, infrequently operated change-over switch designed with a dual power input: power supply (I) serves as the main source, while power supply (II) acts as the standby. It is applicable to AC systems with rated currents from 10 A to 63 A and operating frequencies of 50/60 Hz. Upon failure of the main power (I), the ATSE automatically transfers to the standby power (II) within 20 milliseconds, ensuring continuous power supply and reliable protection against outages.

Technical Data

L2Hxx-xxx/2		L2H20-110/2	L2H40-110/2	L2H63-110/2	L2H20-220/2	L2H40-220/2	L2H63-220/2
IEC Electrical							
Rated Operational Voltage (AC)	U _e	110 V	110 V	110 V	220 V	220 V	220 V
Case Grade		63 A					
Rated Operational Current	I _e	20 A	40 A	63 A	20 A	40 A	63 A
Rated Insulation Voltage (AC)	U _i	690 V					
Rated Impulse Withstand Voltage	U _{imp}	8 kV					
Rated Frequency		50/60 Hz					
Automatic Switching Time		20 ms					
Pole Number		2P					
Usage Category		AC-31B					
Rated Conditional Short-Circuit Current	I _q	50 kA					
Short-Circuit Protection Device (Fuse)		RT16-00-63A					
Rated Impulse Withstand Voltage		8 kV					
TSE Class		PC-Class: Can Be Switched On and Loaded Without Generating Short-Circuit Current					
Control Circuit		Rated Control Voltage Us: AC 230 V, 50/60 Hz Normal Working Conditions: 85% Us-110% Us					
Auxiliary Circuit		230 V, 50/60 Hz, I _e = 5 A					
Overvoltage / Undervoltage Protection Range		Undervoltage Value: 85 V Overvoltage Value: 145 V			Undervoltage Value: 187 V Overvoltage Value: 253 V		
Mechanical Life		≥ 6000 Times					
Electrical Life		≥ 1500 Times					

Order Information

Ordering Code							
L2Hxx-xxx/2	2001260	4001260	6301260	2002260	4002260	6302260	



Product Overview

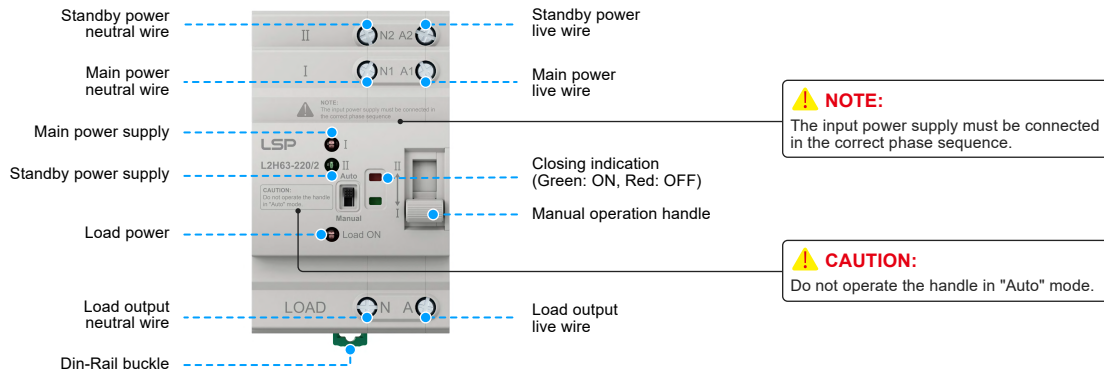

Dimensions & Packaging

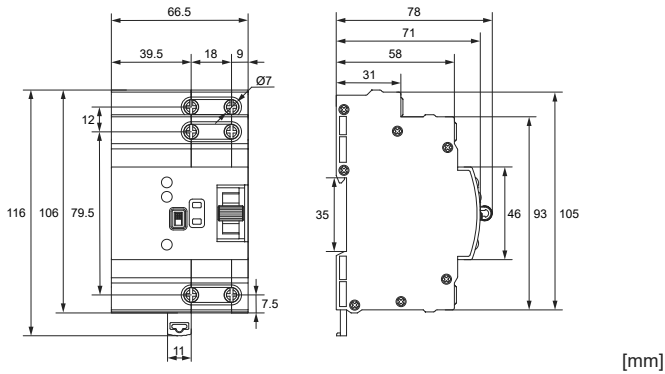

Packing Information

Units per Carton	20 pcs
Product / Inner box / Carton Weight	0.4 kg / 0.01 kg / 0.4 kg
Net / Gross Weight per Carton	8 kg / 8.6 kg
Dimensions (H × W × L)	[185 × 235 × 370 mm]

Easy Installation Instructions

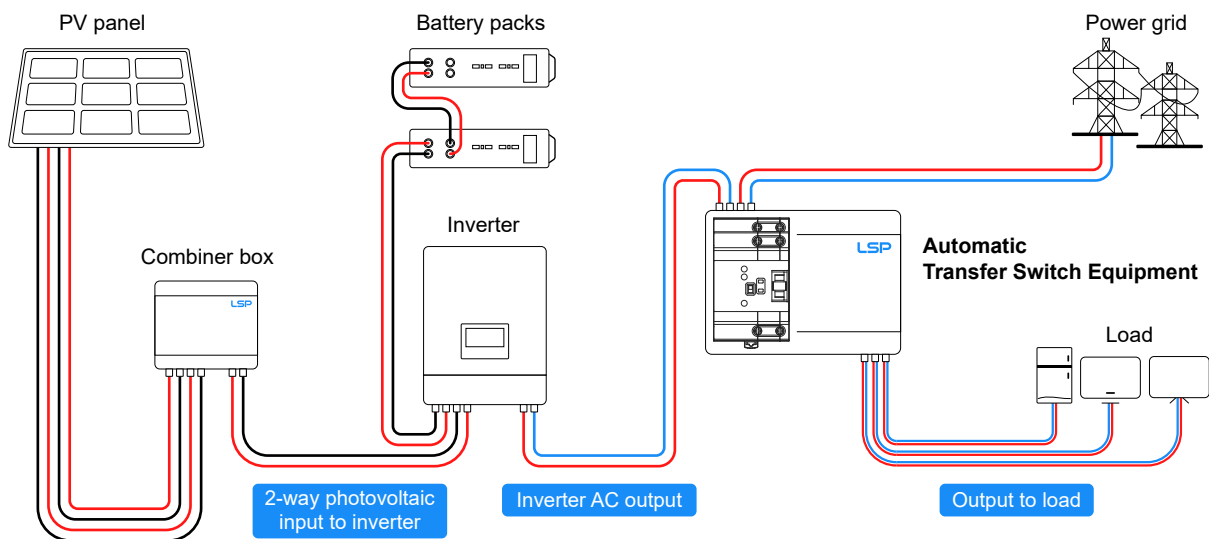

Automatic Transfer Switch Equipment L2Hxx-xxx/4



- PC-Class change-over switch
- Dual power supply design: power supply I (main) and power supply II (standby)
- Supports AC systems with a rated current of 10 A to 63 A
- Automatic switching time 20 milliseconds
- Compliance with IEC 60947-6-1:2021

The L2H Automatic Transfer Switch Equipment (ATSE) is a PC-Class, infrequently operated change-over switch designed with a dual power input: power supply (I) serves as the main source, while power supply (II) acts as the standby. It is applicable to AC systems with rated currents from 10 A to 63 A and operating frequencies of 50/60 Hz. Upon failure of the main power (I), the ATSE automatically transfers to the standby power (II) within 20 milliseconds, ensuring continuous power supply and reliable protection against outages.

Technical Data

L2Hxx-xxx/4		L2H20-110/4	L2H40-110/4	L2H63-110/4	L2H20-220/4	L2H40-220/4	L2H63-220/4
IEC Electrical							
Single-Phase Rated Voltage (phase-to-neutral) (AC)		110 V	110 V	110 V	220 V	220 V	220 V
Rated Operational Voltage (phase-to-phase) (AC)	U _e	200 V	200 V	200 V	400 V	400 V	400 V
Case Grade		63 A					
Rated Operational Current	I _e	20 A	40 A	63 A	20 A	40 A	63 A
Rated Insulation Voltage (AC)	U _i	690 V					
Rated Impulse Withstand Voltage	U _{imp}	8 kV					
Rated Frequency		50/60 Hz					
Automatic Switching Time		20 ms					
Pole Number		4P					
Usage Category		AC-31B					
Rated Conditional Short-Circuit Current	I _q	50 kA					
Short-Circuit Protection Device (Fuse)		RT16-00-63A					
Rated Impulse Withstand Voltage		8 kV					
TSE Class		PC-Class: Can Be Switched On and Loaded Without Generating Short-Circuit Current					
Control Circuit		Rated Control Voltage Us: AC 230 V, 50/60 Hz Normal Working Conditions: 85% Us-110% Us					
Auxiliary Circuit		230 V, 50/60 Hz, I _e = 5 A					
Overvoltage / Undervoltage Protection Range		Undervoltage Value: 85 V Overvoltage Value: 145 V			Undervoltage Value: 187 V Overvoltage Value: 253 V		
Mechanical Life		≥ 6000 Times					
Electrical Life		≥ 1500 Times					

Order Information

Ordering Code	L2Hxx-xxx/4	2001460	4001460	6301460	2002460	4002460	6302460
---------------	-------------	---------	---------	---------	---------	---------	---------



Product Overview

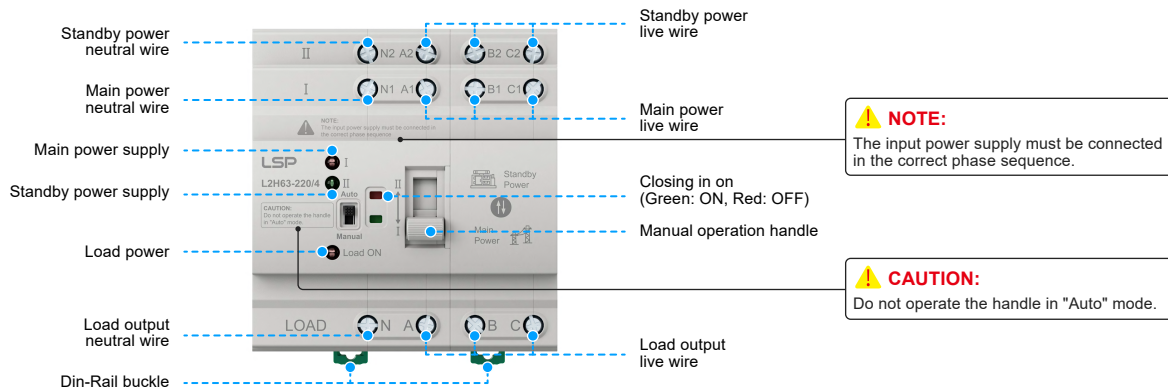

Dimensions & Packaging

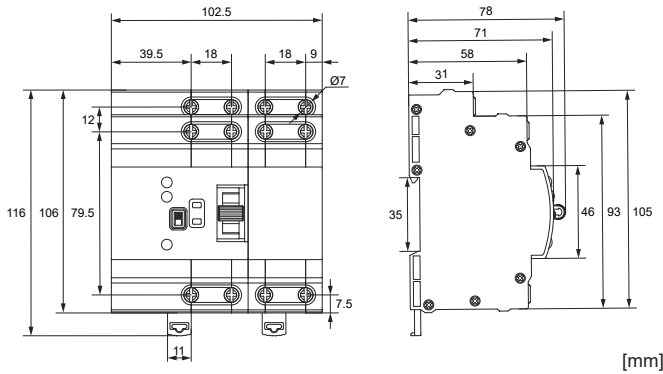

Packing Information

Units per Carton	20 pcs
Product / Inner box / Carton Weight	0.55 kg / 0.05 kg / 0.5 kg
Net / Gross Weight per Carton	11 kg / 12.5 kg
Dimensions (H × W × L)	[185 × 235 × 550 mm]

Easy Installation Instructions

